

### CASE 1 PLAN

N.T.S.

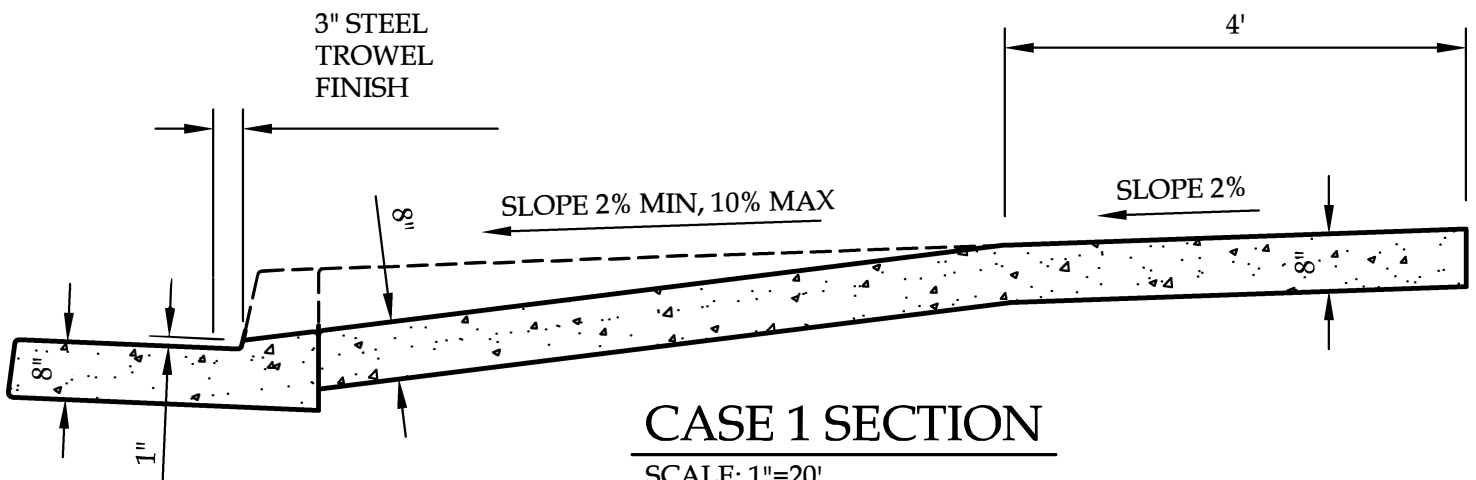

### CASE 1 SECTION

SCALE: 1"=20'

## CITY OF MISSION VIEJO

ARTERIAL HIGHWAY AND  
COMMERCIAL DRIVEWAY APPROACH

307



*Rich Schlinger*

08/01/05

APPROVED BY: CITY ENGINEER RCE 51160

DATE

SHT 1 OF 3

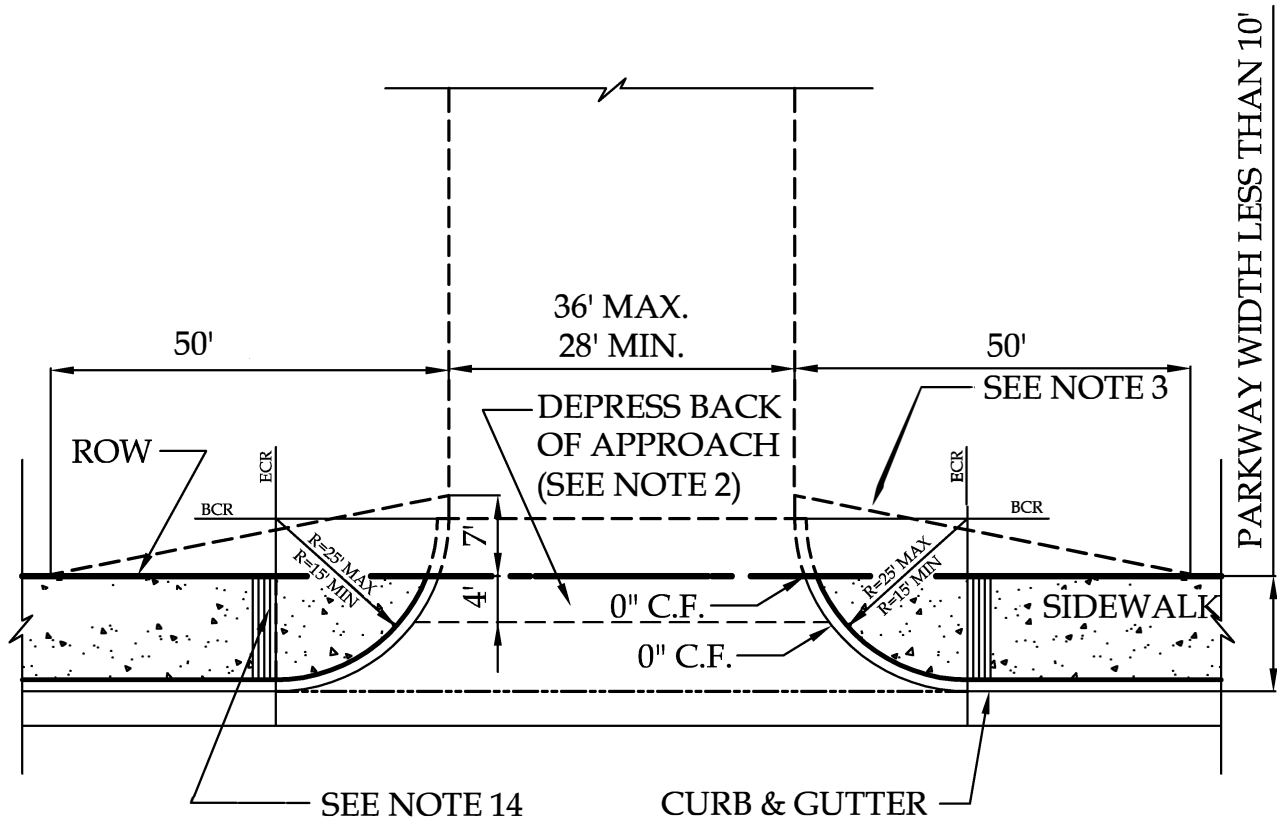

**CASE 2 PLAN**  
N.T.S.

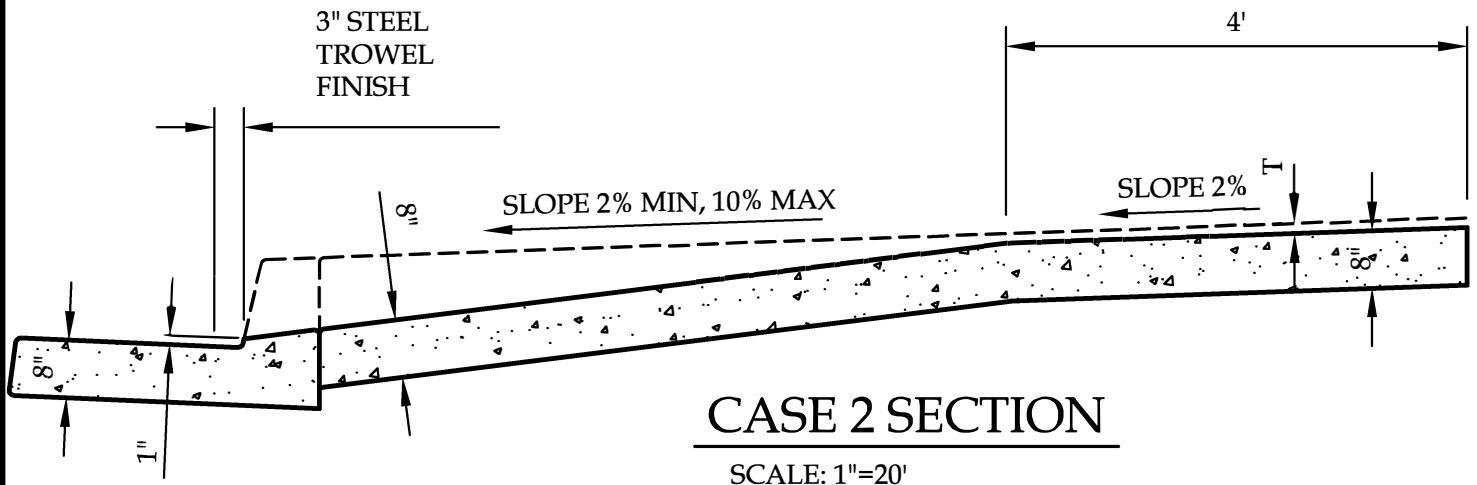

**CASE 2 SECTION**  
SCALE: 1"=20'

**CITY OF MISSION VIEJO**

ARTERIAL HIGHWAY AND  
COMMERCIAL DRIVEWAY APPROACH



*Rich Schlinger*

APPROVED BY: CITY ENGINEER RCE 51160

08/01/05

DATE

307

SHT 2 OF 3

# NOTES:

1. "R" LESS THAN 25' WILL REQUIRE APPROVAL OF THE CITY ENGINEER.
2. FOR PARKWAY WIDTH LESS THAN 10' BUT GREATER THAN OR EQUAL TO 9' (T) = 1". FOR PARKWAY WIDTH LESS THAN 9' BUT GREATER THAN OR EQUAL TO 8' (T) = 2". FOR PARKWAY WIDTH LESS THAN 8' SPECIAL DESIGN AND APPROVAL BY CITY ENGINEER IS REQUIRED.
3. SIGHT DISTANCE AREA TO BE CLEAR OF ANY VISUAL OBSTRUCTION ABOVE 12" HEIGHT.
4. WEAKENED-PLAN JOINTS SHALL BE INSTALLED AT BOTH SIDES OF THE DRIVEWAY AND AT APPROXIMATELY 10' INTERVALS, AND AT THE R/W.
5. CONCRETE SHALL BE CLASS 520-C-2500 WITH MAXIMUM SLUMP OF 4".
6. UNDER NO CIRCUMSTANCES WILL SAW CUTTING IN THE GUTTER FLOW LINE TO REMOVE THE CURB BE ALLOWED.
7. 6 INCHES OF BASE MATERIAL IS REQUIRED UNDER ALL CONCRETE.
8. WEAKENED PLANE JOINTS SHALL BE 1 ½ INCHES DEEP WITH ⅛ INCH RADIUS EDGES.
9. FOR NEW DRIVEWAY CONSTRUCTION ON EXISTING ROADWAYS, 12 INCHES OF ASPHALT FROM THE EDGE OF THE GUTTER SHALL BE REMOVED.
10. ACCESS RAMPS SHALL COMPLY WITH TITLE 24 AND ADA REQUIREMENTS.
11. CURB & GUTTER AND RAMP/ APPROACH SHALL NOT BE MONOLITHIC.
12. IF SIDEWALK IS LOCATED OUTSIDE OF THE PUBLIC RIGHT OF WAY A SIDEWALK EASEMENT SHALL BE DEDICATED TO THE CITY OF MISSION VIEJO.
13. RADIUS OF CURB RETURNS SHALL BE SYMMETRICAL.
14. INSTALL BORDER PER STANDARD PLAN 322.
15. EXPANSION JOINT SHALL BE INSTALLED AT PUBLIC ROW LINE (IF NECESSARY).

## CITY OF MISSION VIEJO



ARTERIAL HIGHWAY AND  
COMMERCIAL DRIVEWAY APPROACH

307

*Rich Schlinger*

08/01/05

APPROVED BY: CITY ENGINEER RCE 51160

DATE

SHT 3 OF 3