

#5 BARS HOOKED AT EACH END.
(TYPICAL) TOTAL: 11

#4 BARS HOOKED AT EACH END.
(TYPICAL) TOTAL: 16

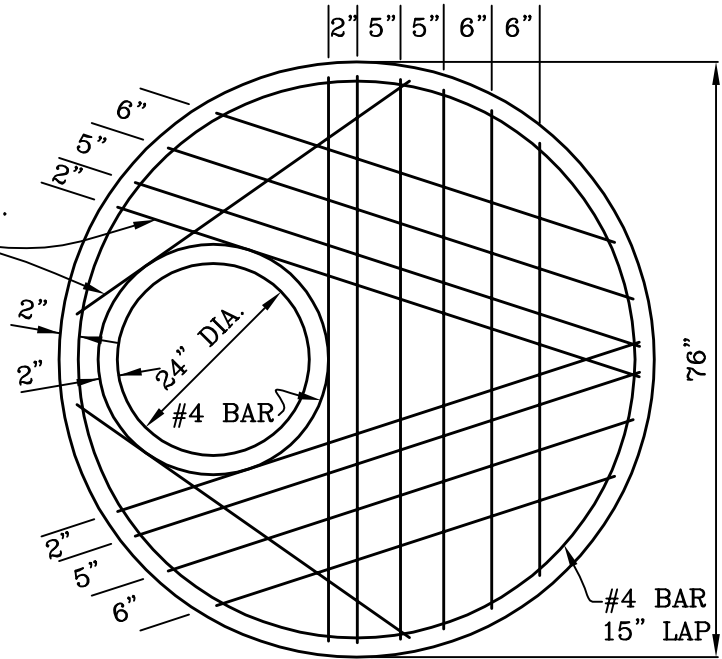

PLAN OF 60" COVER WITH
24" ACCESS

NOTES:

1. SEE STD. PLAN 424 FOR MANHOLE FRAME AND COVER.
2. SEE STD. PLAN 422 FOR MANHOLE STEPS. MAX. SPACING = 17".
3. SEE STD. PLAN 416 FOR RING AND MANHOLE PIPE.
4. CONSTRUCTION SHALL BE IN ACCORDANCE WITH STANDARD SPECIFICATIONS FOR PUBLIC WORKS CONSTRUCTION.

CITY OF MISSION VIEJO



FLAT TOP MANHOLE COVERS

STANDARD
PLAN NO.

420

Robert Anderson

9-23-03

APPROVED

RCE 30190

DATE

SHT 2 OF 2